



Krata do regulacji przysunąć do krawężnika i wysekosciowo do nawierzchni

Krata do regulacji przysunąć do krawężnika i wysekosciowo do nawierzchni

Krata do regulacji przysunąć do krawężnika i wysekosciowo do nawierzchni

Krata do regulacji przysunąć do krawężnika i wysekosciowo do nawierzchni

Krata do regulacji przysunąć do krawężnika i wysekosciowo do nawierzchni

*zjazd użyciem*

*-zjazd do użyciem*

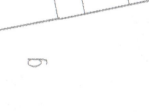
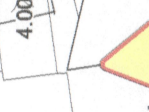
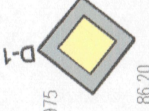
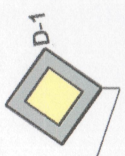
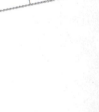
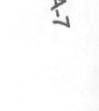
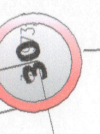
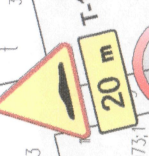

M. Ogińskiego

kostka

PCV-d315

PCV-d315

PCV-d315

PCV-d315

PCV-d315

PCV-d315

PCV-d315

PCV-d315

PCV-d315

PCV-d315

PCV-d315

PCV-d315

PCV-d315

PCV-d315

PCV-d315

PCV-d315

PCV-d315

PCV-d315

PCV-d315

PCV-d315

PCV-d315

PCV-d315

PCV-d315

PCV-d315

PCV-d315

PCV-d315

PCV-d315

PCV-d315

PCV-d315

PCV-d315

PCV-d315

PCV-d315

PCV-d315

PCV-d315

PCV-d315

PCV-d315

PCV-d315

PCV-d315

PCV-d315

PCV-d315

PCV-d315

PCV-d315

PCV-d315

PCV-d315

PCV-d315

PCV-d315

PCV-d315

PCV-d315

PCV-d315

PCV-d315

PCV-d315

PCV-d315

PCV-d315

PCV-d315

PCV-d315

PCV-d315

PCV-d315

PCV-d315

PCV-d315

PCV-d315

PCV-d315

PCV-d315

PCV-d315

PCV-d315

PCV-d315

PCV-d315

PCV-d315

PCV-d315

PCV-d315

PCV-d315

PCV-d315

PCV-d315

PCV-d315